

CLAD SINGLE HUNG | DOUBLE HUNG WINDOW INSTALLATION GUIDE

READ SPECIFIC INSTALLATION INSTRUCTIONS COMPLETELY BEFORE STARTING ANY INSTALLATION

Failure to install and maintain our product according to these instructions will VOID any warranty, written or implied. The installer is responsible for consulting the contractor, structural engineer, architect, or consumer, for proper installation according to local codes and/or ordinances.

WARNING

Every assembly and installation is different from Parrett Windows & Doors. Parrett strongly recommends consultation with a Parrett supplier or an experienced contractor, architect, or structural engineer prior to the assembly and installation of any Parrett product. **PARRETT HAS NO RESPONSIBILITY IN REGARD TO POST-MANUFACTURED ASSEMBLY AND INSTALLATION OF PARRETT PRODUCTS.**

CAUTION

Factory applied exterior Brickmould and casing DO NOT take the place of standard window flashing. Each unit must be properly flashed and sealed with silicone for protection against water and air infiltration.

WARNING TO INSTALLER

- Using ladders and/or scaffolding and working at elevated levels can be very dangerous. Follow the manufacturer's instructions for all equipment used in order for safe operation. Please use extreme caution when working around window or door openings. Falling from opening may result in injury or death.
- Improper use of hand/power tools could result in injury and/or product damage. Again, follow manufacturer's instructions for safe operation of equipment. **ALWAYS WEAR SAFETY GLASSES.**
- Windows and doors can be very heavy and improper lifting techniques can result in serious injury. Use safe lifting techniques and a reasonable number of people with enough strength to lift, carry, and install any Parrett window and door products to avoid injury and/or damage to any product.

ITEMS REQUIRED BY INSTALLER

- Safety Glasses
- Tape Measure
- Level
- Hammer
- Putty Knife
- Carpenter's Square
- Caulk Gun
- Phillips Screwdriver
- Power Drill
- Hex Wrench
- 3/16" Drill Bit
- Foam Backer Rod
- UV Resistant Exterior Sealant
- ¼" Blocks
- Shims
- Stainless Steel Fasteners
 - 3" Finish Nails
 - #10 x 1" Pan Head Screws
 - #10 x 1-1/2" Screws
 - #10 x 2-1/2" Screws
 - 1 ¾" Roofing Nails



1. Unit Preparation

- Remove unit from packing making sure to not damage the unit. Place unit exterior side down on a clean flat work surface.
- Remove any loose items. Extension jamb will be factory applied unless ordered loose.

WARNING

Make sure unit is locked and **DO NOT** open sash during installation. Frame may become twisted and result in problems with performance.

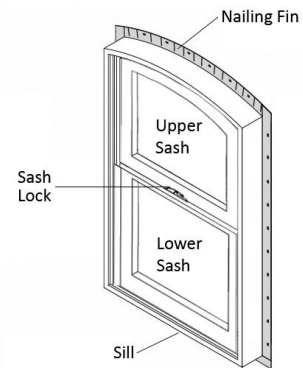

SINGLE | DOUBLE HUNG

2. Prepare Rough Opening

- Size of rough opening should allow minimum $\frac{1}{4}$ " clearance around entire unit, between frame and rough opening. The width and height of the rough opening should be $\frac{1}{2}$ " more than unit width and height.
- Make sure the rough opening is square by measuring diagonally, from upper right to lower left, and upper left to lower right corner. The measurements need to be within $\frac{1}{8}$ " for the opening to be square. If the rough opening is not square, it **MUST** be corrected before installation.
- Check to make sure rough opening is plumb and level using a carpenter's square and level. The sill plate **MUST** be level. If rough opening is not plumb or level, correct before installation.

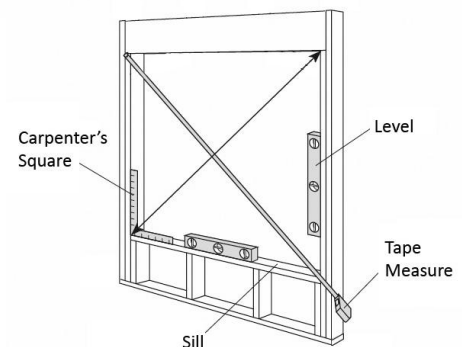
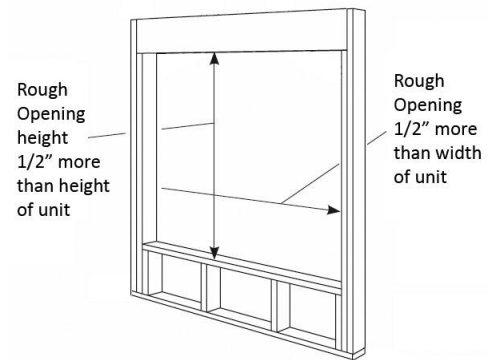

3. Installation Clips (If applicable)

- Rotate Installation Clips into position around frame, as shown, before placing unit into rough opening.
- If installation clips are not installed, install clips along the frame of the unit before installation.
- All installation clips **MUST BE** corrosion resistant.

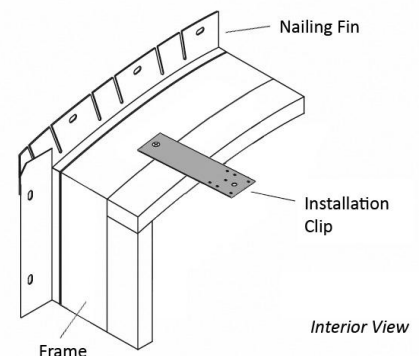

Interior View



4. Unit Installation

- Apply a 3/8" bead of UV resistant exterior sealant to back of Nailing Fin.
- Lift unit into rough opening from the exterior.
- Place 1/4" blocks at the corners of the sill under side jambs. Add shims along the rough opening to support and level unit as needed. For mullied units, shims must be placed under mullion post(s) at sill. All mull connections need to be properly sealed. It is necessary to consult with contractor, structural engineer, architect or building owner for proper installation. Minimum recommendation would be to apply a 1/4" bead of caulk to the wood jamb and a 3/8" bead of caulk to the nailing fin receiving channel on each unit. Finally, the mull connector needs to be applied making certain all joints are tightly sealed and the mull cap is firmly in place.
- Center, square and level unit in opening.
- Bend and fasten Installation Clip at the highest point with a minimum #10 x 1" corrosion resistant pan head screw. (If Applicable)

WARNING

UV resistant exterior sealant must be compatible with all materials it comes in contact with. Follow sealant manufacturer's instructions regarding surface cleaning and preparation, application, and temperature when applying sealant. Failure to do so may result in water infiltration. Metal fasteners and other hardware components may corrode when exposed to preservative treated and fire-retardant treated lumber. Failure to use appropriate materials for installation may cause failure resulting in injury, property or product damage.

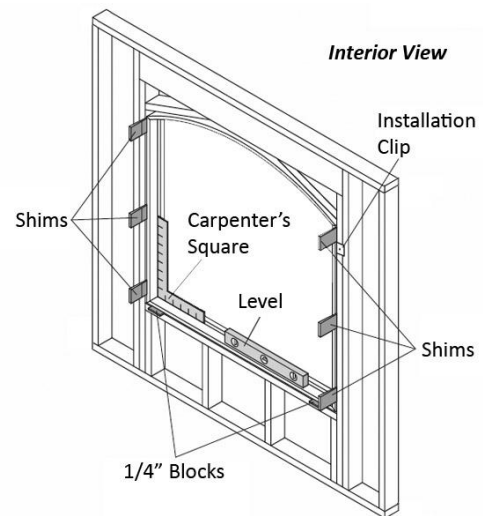
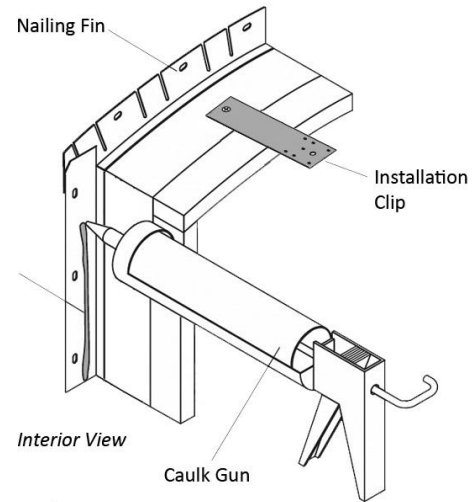

5. Secure Unit in Opening

WOOD FRAME CONSTRUCTION

- Insert shims between frame and rough opening along the side jambs, just above or below Installation Clips.
- Check plumb, level, and square of unit. Adjust shims as needed.
- Nail through every hole around the Nailing Fin using 1-3/4" roofing nails.

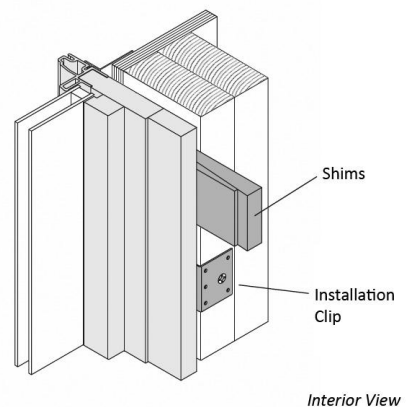



5. Secure Unit in Opening (continued)

- Bend and fasten Installation Clips to building structure using a minimum #10 x 1" screw.
- Recheck plumb, level and square of unit.

NOTICE

Both Installation Clips and nailing through Nailing Fin are recommended for installing all units. If both cannot be used, unit must also be secured to building structure through frame.

- If securing through the frame, pre-drill 3/16" holes through unit frame 4" from each corner and every 16" in between.
- Insert shims between frame and rough opening near 3/16" holes.
- Check plumb, level and square of unit. Adjust shims as needed.
- Secure unit through pre-drilled holes in frame using #10 x 2-1/2" screws.
- Recheck plumb, level and square of unit. Correct as needed.

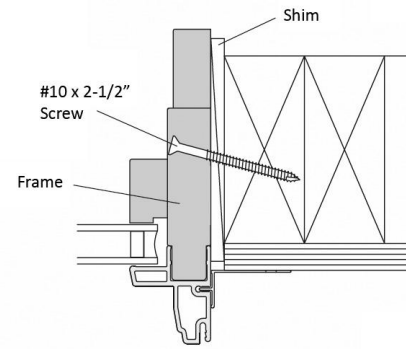
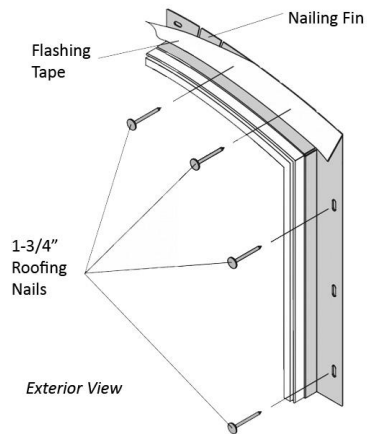

WOOD FRAME CONSTRUCTION

MASONRY CONSTRUCTION

CAUTION

DO NOT install unit with unfinished wood in direct contact with masonry/concrete. Apply proper finish to wood surface, or place barrier (i.e. tar paper or ice/water membrane) between wood and masonry/concrete surface. Failure to do so may result in product and/or property damage.

NOTICE

For masonry applications, install and securely fasten a wood buck or wood blocking around masonry opening before installing the window.

- Insert shims between frame and rough opening along the side jambs, just above or below Installation Clips.
- Bend and fasten Installation Clip at middle of each jamb to masonry, wood blocking, or wood buck using a minimum #10 x 1" corrosion resistant screw.

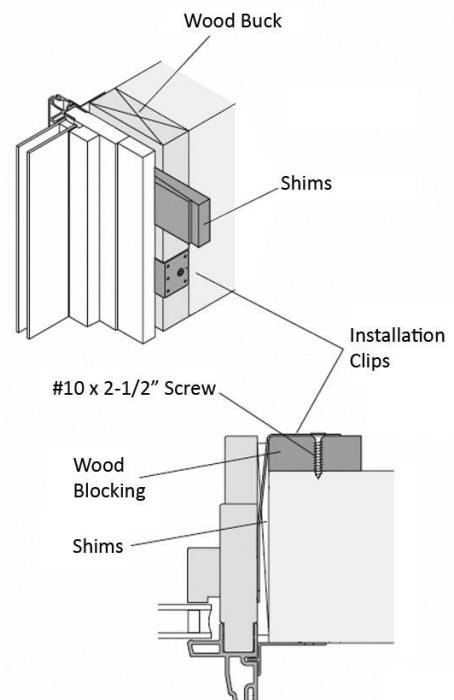



5. Secure Unit in Opening (continued)

- If Installation Clips are being secured directly to masonry, pre-drill hole and use masonry screws.
- Check plumb, level, and square of unit. Adjust shims as needed.
- Secure remaining Installation Clips.
- Recheck plumb, level and square of unit.
- If securing through the frame, drill 3/16" holes through unit frame 4" from each corner and every 16" in between. If securing directly to masonry, pre-drill masonry for #10 x 2-1/2" masonry screws.
- Insert shims between frame and rough opening near 3/16" holes.
- Check plumb, level, and square of unit. Adjust shims as needed.
- Secure unit through frame using #10 x 2-1/2" screws. Use masonry screws if needed.
- Recheck plumb, level and square of unit. Correct as needed.

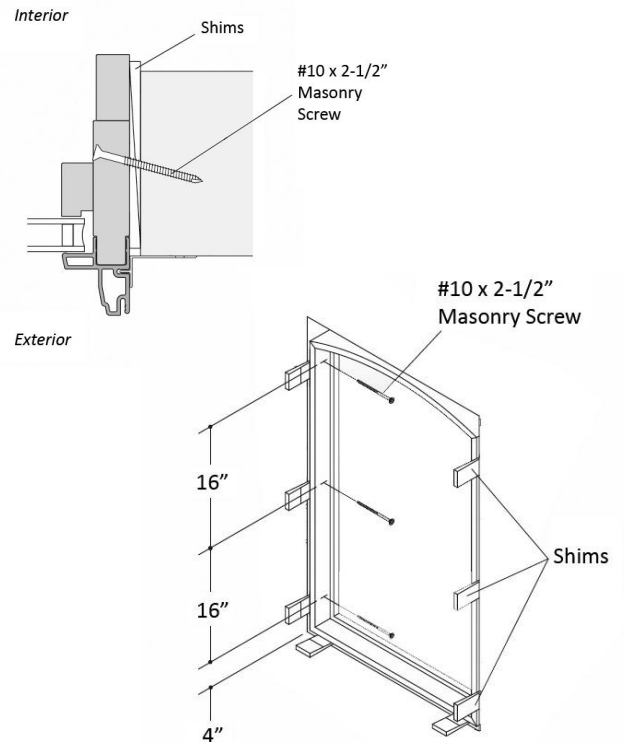

Masonry Construction

Interior View

6. Check Clearance and Operation

- Unlock sash and make sure they move freely.
- Check unit for square by measuring diagonally, upper left corner to lower right and upper right to lower left corner. Measurements should be within 1/8" for proper install. Check that unit is plumb by using a level and carpenter's square. Adjust installation clips and shims as needed.
- Measure across head, center, and sill of unit. Center dimension should match head and sill dimensions. Adjust shims to straighten side jambs as needed.

WARNING

Metal fasteners and other hardware components may corrode when exposed to preservative treated and fire retardant treated lumber. Use the appropriate metal fasteners as called out by the hardware installation guide. Failure to use appropriate materials for the installation may cause a failure resulting in injury, property or product damage.

Please follow any/all instructions that are set forth by the hardware manufacturing company. Warranty will be **VOID** if correct procedures/operation is not followed.

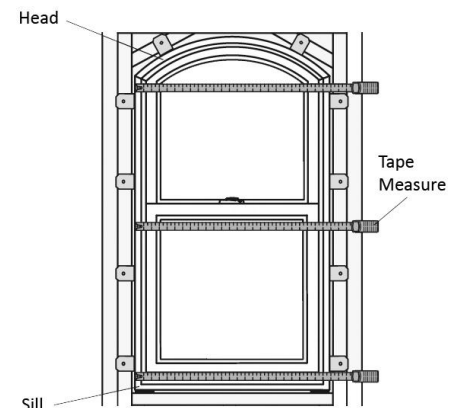
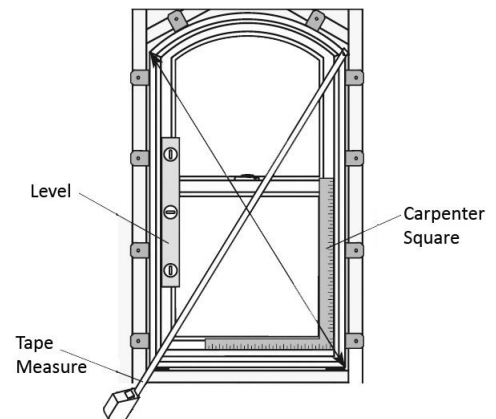



7. Apply Flashing Tape

- Apply a continuous bead of UV resistant exterior sealant between the Nailing Fin and the exterior cladding of the window. This will seal the Nailing Fin to unit frame.
- Apply flashing tape over the Nailing fin at the sill of the window.
- Next apply flashing tape over the Nailing Fin on both sides of the unit and make sure to overlap tape at the sill.
- Finally apply flashing tape over the Nailing Fin at the head, making sure to overlap flashing tape at the sides.

CAUTION

Unit must be properly flashed and sealed for protection against water and air infiltration. You **MUST** use non-reflective flashings. Highly reflective flashing tapes can raise the surface temperature of vinyl to the point where the vinyl may melt or cause deformation.

NOTICE

This instruction step depicts one of the many options for proper flashing. Moisture infiltration problems in any type of building can be reduced by properly flashing and/or sealing around all building openings, including windows and doors. Proper flashing under and around window and door openings can reduce moisture problems, but the performance of any building system depends upon the design and construction of the building system in its entirety, which should address local environmental, climate, building codes and product and material limitations. The design and installation of flashing and sealing systems are the responsibility of the architect, contractor, installer, and/or the manufacturer of the building exterior specified for the project.

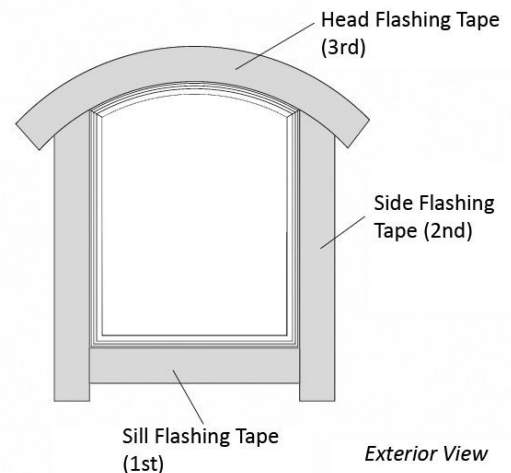
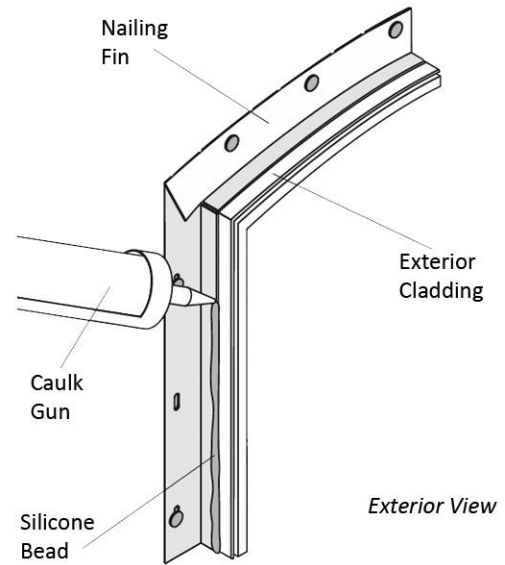

8. Adjustments

NOTICE

Make sure any adjustments made to the unit are recommended by Parrett Windows & Doors. Any adjustments that are **NOT** set forth in the installation instructions will **VOID** any warranty set forth. Install hardware as directed in the supplied instructions by the manufacturer. Parrett used numerous types of hardware and each instruction must be followed.

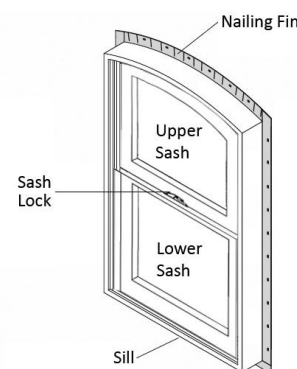

9. Insulate Around Unit

CAUTION

When insulating between unit frame and rough opening, or between units when joining, **DO NOT** over-pack insulation or overfill with expandable foam. Bowed jambs may result causing product performance problems. Follow insulation manufacturer's instructions.

Insulate between frame, extension jambs, and rough opening on all sides. **DO NOT** over pack insulation or overfill with expandable foam.

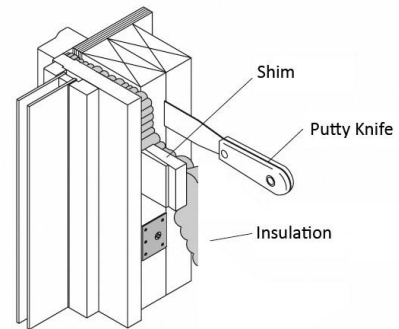

Interior View

10. Apply Exterior Finish

NOTICE

Use foam backer rod to seal and reduce the depth of gap before filling with silicone sealant. Follow silicone sealant manufacturer's instructions.

- A minimum space of ¼" is required around the exterior perimeter of unit between frame and siding. Masonry/brick veneer installations require a minimum ½" space along the sill and ¼" space around the remaining perimeter. Failure to do so may result in product and/or property damage.
- Apply backer rod and a continuous bead of UV resistant exterior sealant around exterior perimeter of window unit between exterior window frame cladding and exterior finish.

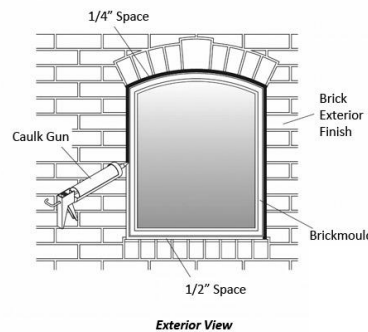

Exterior View

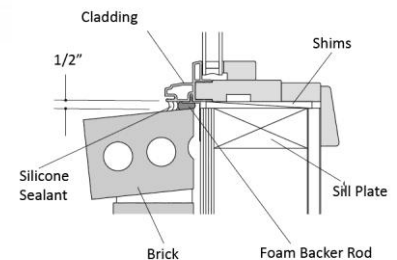

11. Finishing, Cleaning, and Maintenance Instructions

Refer to Parrett's *Care and Maintenance* Instructions for all cleaning and maintenance. For finishing instructions, refer to Parrett's *Homeowner's Manual* at www.parrettwindows.com or contact customer service at 1-800-541-9527.

Parrett will not under any circumstances be responsible for installation, repainting, refinishing or other similar activities necessary to complete any replacement. It is the consumer's responsibility for installation, finishing, cleaning, maintenance, re-painting, refinishing or other similar activities necessary to maintain the performance of each window.

Failure to install and maintain our product according to these instructions will VOID any warranty, written or implied. The installer is responsible for consulting the contractor, structural engineer, architect, or consumer, for proper installation according to local codes and/or ordinances.